

N. 71. 234

Gilbert Vought.

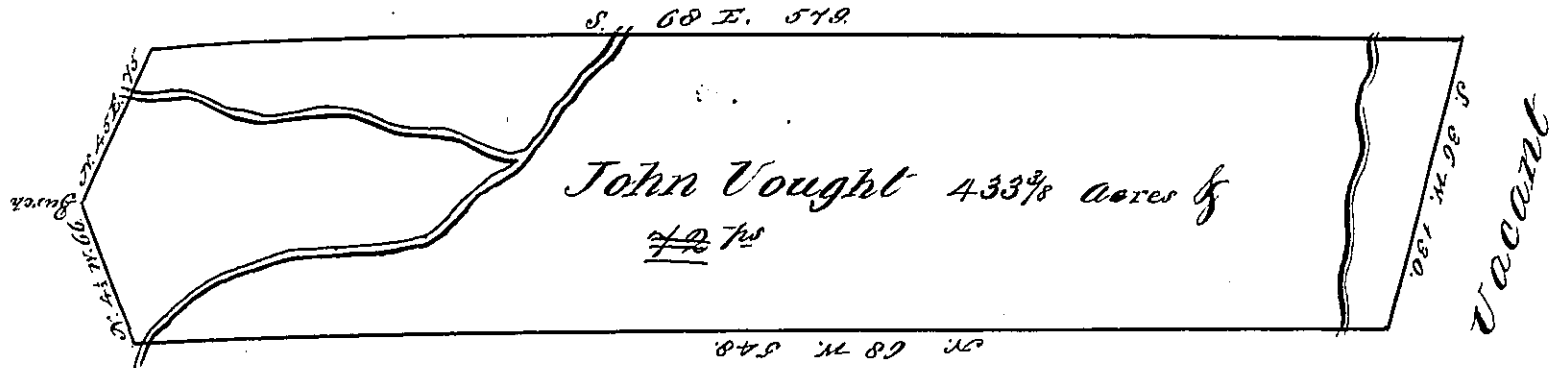

Jonathan Wales.

D. 12 - 109

A draught of a Tract of Land Situate on  
 Marshannon Creek Joining Land of Jonathan  
 Wales & Land of Gilbert Vought in the County  
 of Bedford Containing four hundred and  
 thirty three Acres & ~~Twenty~~ two  $\frac{3}{8}$  perches &  
 the usual allowance of Six per. Cent for  
 Roads - Surveyed the 26<sup>th</sup> day of October  
 1784 In Pursuance of a Warrant granted  
 to John Vought dated 1<sup>st</sup> July 1784 -

By John Lukens Esq<sup>r</sup>  
 Sg.

George Woods S.S.

IN TESTIMONY that the above is a copy of the original remaining on file in the  
 Department of Internal Affairs of Pennsylvania, made con-  
 formably to an Act of Assembly approved the 16th day of  
 February, 1833, I have hereunto set my Hand and caused  
 the Seal of said Department to be affixed at Harrisburg, this

Ninety third day of October 1876

James Mandlep  
 Secretary of Internal Affairs